

STAINLESS STEEL FLEX

This type of flex is designed to take high temperatures, such as those found in diesel engine applications. Stainless flex does have a tendency to discolour when exposed to these high-operating temperatures.

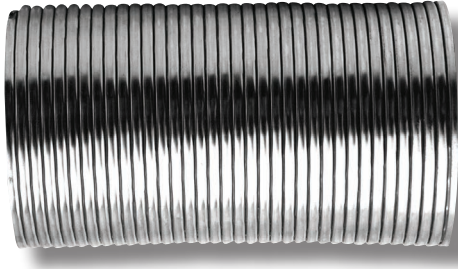

Flexible Tube 3 Metre Length

| ID Tube | | Part No. |
|---------|------|----------|
| 51mm | 2" | 0155051 |
| 63mm | 2 ½" | 0155063 |
| 76mm | 3" | 0155076 |
| 89mm | 3 ½" | 0155089 |
| 102mm | 4" | 0155102 |
| 114mm | 4 ½" | 0155114 |
| 127mm | 5" | 0155127 |
| 152mm | 6" | 0155152 |

RIGID TUBE - STANDARD LENGTHS BY METRE

| Tube OD | | Gauge mm | Length | Mild Steel | Aluminised | Aluminium |
|---------|-----|----------|--------|------------|------------|-----------|
| 51mm | 2" | 1.6 | 3 | 0151051 | 0152051 | |
| 63mm | 2½" | 1.6 | 3 | 0151063 | 0152063 | |
| 76mm | 3" | 1.6 | 3 | 0151076 | 0152076 | |
| 89mm | 3½" | 1.6 | 3 | 0151089 | 0152089 | |
| 102mm | 4" | 1.6 | 3 | 0151102 | 0152102 | 154102 |
| 114mm | 4½" | 1.6 | 3 | 0151114 | 0152114 | |
| 127mm | 5" | 1.32 | 3 | | | 154127 |
| 127mm | 5" | 1.6 | 3 | 0151127 | 0152127 | |
| 140mm | 5½" | 1.6 | 3 | 0151140 | 0152152 | |
| 152mm | 6" | 1.47 | 3 | | | 154152 |
| 152mm | 6" | 1.6 | 3 | 0151152 | | |
| 178mm | 7" | 1.52 | 3 | 0151178 | | 89665K |
| 203mm | 8" | 1.63 | 3 | | | 89666K |
| 203mm | 8" | 2 | 3 | 0151203 | | |

Tube and flex are available in full lengths or cut to order - a cutting charge may apply.



FLEX (BELLOWS) CONNECTORS

Stainless Steel flex with aluminised end, maximum bend 10° - 18" long

Diameter

| ID | | Part No. |
|-------|------|----------|
| 89mm | 3 ½" | 89787K |
| 152mm | 6" | 89790K |

EXHAUST CLAMPS

Guillotine

Flat Band

Wide Band Lap

Wide Band Butt

Flat Band Easy



| Clamp Size | Zinc Plated Part No. | Zinc Plated Part No. | Aluminised Part No. | Aluminised Part No. | Stainless Part No. |
|----------------|----------------------|----------------------|---------------------|---------------------|--------------------|
| 51mm - 2" | 89541K | | 90350A | | |
| 57mm - 2 1/4" | 89542K | | 90351A | 0162140622 | |
| 63mm - 2 1/2" | 89543K | | 90352A | 0162141025 | 89523K |
| 70mm - 2 3/4" | 89544K | | 90353A | | |
| 76mm - 3" | 89545K | 89556K | 90354A | 0162141830 | 89525K |
| 89mm - 3 1/2" | 89547K | 89557K | 90355A | 0162142235 | 89526K |
| 102mm - 4" | 89548K | 89558K | 90356A | 0162142640 | 89527K |
| 114mm - 4 1/2" | 90092A | | 90357A | 0162142845 | |
| 127mm - 5" | 89549K | 89559K | 90358A | 0162143050 | 89528K |
| 152mm - 6" | 89550K | 89560K | 90359A | | 89529K |

Enquire if your size not listed

Some Zinc Plated clamps are available in Chrome Plated

BENDS - 45° STANDARD



Available in: Stainless steel, Mild steel and Chrome plated. Aluminised steel (16 gauge). Also available in expanded or notched. CLR = 1.5 x diameter. 50mm Straights.

| OD | | Part No. | CLR |
|-------|--------|-----------|--------------|
| 51mm | 2" | 010105145 | 76mm 3" |
| 63mm | 2 1/2" | 010106345 | 95mm 3 3/4" |
| 76mm | 3" | 010107645 | 114mm 4 1/2" |
| 89mm | 3 1/2" | 010108945 | 134mm 5 1/4" |
| 102mm | 4" | 010111445 | 152mm 6" |
| 127mm | 5" | 010112745 | 203mm 8" |
| 152mm | 6" | 010115245 | 229mm 9" |

BENDS - 45° STANDARD LONG LEG

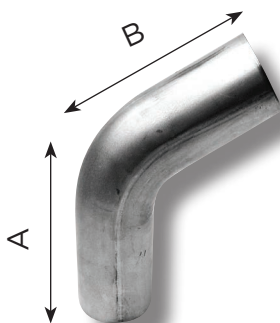

Available in: Chrome plated. Aluminised steel (16 gauge). Also available in expanded or notched.

| OD | | Part No. | CLR | Leg Length | |
|-------|--------|-----------|--------------|------------|-------|
| | | | | A | B |
| 63mm | 2 1/2" | 010306345 | 95mm 3 3/4" | 300mm | 600mm |
| 76mm | 3" | 010307645 | 114mm 4 1/2" | 295mm | 550mm |
| 89mm | 3 1/2" | 010308945 | 134mm 5 1/4" | 300mm | 550mm |
| 102mm | 4" | 010310245 | 152mm 6" | 280mm | 565mm |
| 127mm | 5" | 010311445 | 203mm 8" | 320mm | 530mm |
| 152mm | 6" | 010312745 | 229mm 9" | 400mm | 600mm |

BENDS - 90° STANDARD



Available in: Stainless steel. Mild steel. Chrome plated.
Aluminised steel (16 gauge). Also available in expanded or notched.
CLR = 1.5 x diameter. 50mm Straights.

| OD | | Part No. | CLR | |
|-------|-----|-----------|-------|-----|
| 51mm | 2" | 010105190 | 76mm | 3" |
| 63mm | 2½" | 010106390 | 95mm | 3¾" |
| 76mm | 3" | 010107690 | 114mm | 4½" |
| 89mm | 3½" | 010108990 | 134mm | 5¼" |
| 102mm | 4" | 010110290 | 152mm | 6" |
| 114mm | 4½" | 010111490 | 171mm | 6¾" |
| 127mm | 5" | 010112790 | 203mm | 8" |
| 152mm | 6" | 010115290 | 229mm | 9" |
| 152mm | 6" | 010115245 | 229mm | 9" |

BENDS - 90° STANDARD LONG LEG



Available in: Mild steel. Aluminised steel (16 gauge)
CLR = 1.5 x diameter.
.6mm Wall. Leg lengths can be specially manufactured to suit individual specifications. Minimum order quantities may apply.

| OD | | Part No. | Leg Length (A) | (B) |
|-------|-----|-----------|----------------|-------|
| 63mm | 2½" | 010306390 | 284mm | 500mm |
| 76mm | 3" | 010307690 | 295mm | 600mm |
| 89mm | 3½" | 010308990 | 300mm | 600mm |
| 102mm | 4" | 010310290 | 350mm | 570mm |
| 114mm | 4½" | 010311490 | 388mm | 543mm |
| 127mm | 5" | 010312790 | 480mm | 600mm |
| 152mm | 6" | 010315290 | 400mm | 600mm |

BENDS - 90° SHORT RADIUS



Available in: Mild steel. Chrome plated.
Aluminised steel (16 gauge) CLR = 1 x diameter.
For use in tight places where clearance is a problem.

| OD | | Part No. | Leg Length A x B |
|-------|-----|-----------|------------------|
| 76mm | 3" | 016007690 | 152 x 329mm |
| 89mm | 3½" | 016008990 | 165 x 229mm |
| 102mm | 4" | 016010290 | 178 x 254mm |
| 127mm | 5" | 016012790 | 203 x 437mm |
| 152mm | 6" | 016015290 | 254 x 254mm |

V-BAND CLAMPS



V-Band Clamps are made of Type 321 Stainless Steel. The function of a V-Band clamp is to connect the manifold, or turbocharger to the exhaust system. These type of clamps are designed to cater to the majority of engine applications and are available in a variety of sizes.

| Tube ODP/N. | Applications | A | B | C | D | E | F | Max Flange OD |
|-------------|---------------|-----|----------------|---------------|---------------|--------------|--------------|----------------|
| 3.00" | Cummins V903 | 40° | 3.88" 99mm | 0.40" 10mm | 0.88" 22mm | 0.28" 7mm | 0.05" 1mm | 3.76" 96mm |
| 3.00" | Detroit 6V71 | 40° | 3.82" 97mm | 0.21" 5mm | 0.88" 22mm | 0.28" 7mm | 0.08" 2mm | 3.70" 94mm |
| 3.50" | Cummins VT555 | 40° | 4.25" 108mm | 0.40" 10mm | 0.88" 22mm | 0.28" 7mm | 0.05" 1mm | 4.16" 106mm |
| 4.00" | Detroit 6-71 | 40° | 4.91" 125mm | 0.29" 7mm | 1.13" 29mm | 0.30" 8mm | 0.09" 2mm | 4.79" 122mm |
| 5.00" | Cummins M11 | 40° | 5.88" 149mm | 0.40" 10mm | 0.88" 22mm | 0.28" 7mm | 0.05" 1mm | 5.79" 147mm |
| 5.00" | Detroit 8V71 | 40° | 5.87" 149mm | 0.37" 9mm | 0.88" 22mm | 0.30" 8mm | 0.05" 1mm | 5.75" 146mm |

Cummins

Detroit

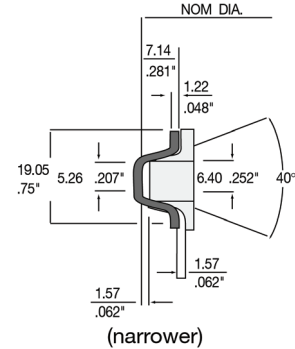
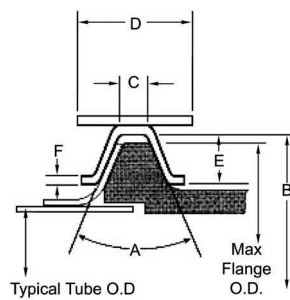
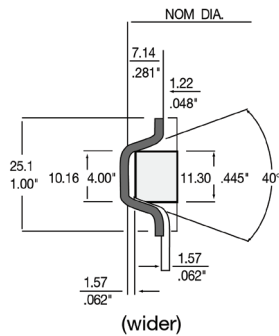

DONUTS



| Size | Part No. |
|------|----------|
| 2½" | 0190063 |
| 3" | 0190076 |
| 3½" | 0190089 |
| 4" | 0190102 |
| 5" | 0190127 |
| 6" | 0190152 |

'Y' JUNCTION



Available in:

Mild Steel

A 'Y' Junction provides equal gas flow by converting a single system exhaust pipe into a dual.