

TIE ROD ENDS

Polished, full ball design for medium and heavy-duty applications provides full bearing contact ensuring a superior range of motion. Grease passages allow consistent lubrication.

MALE THREAD

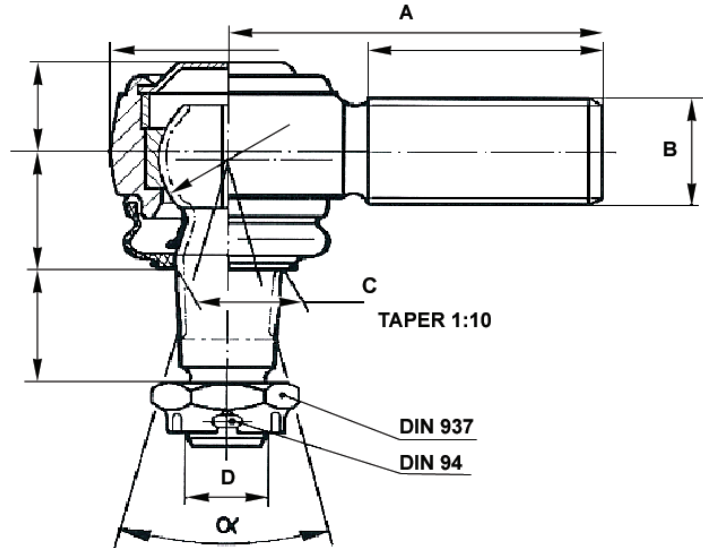
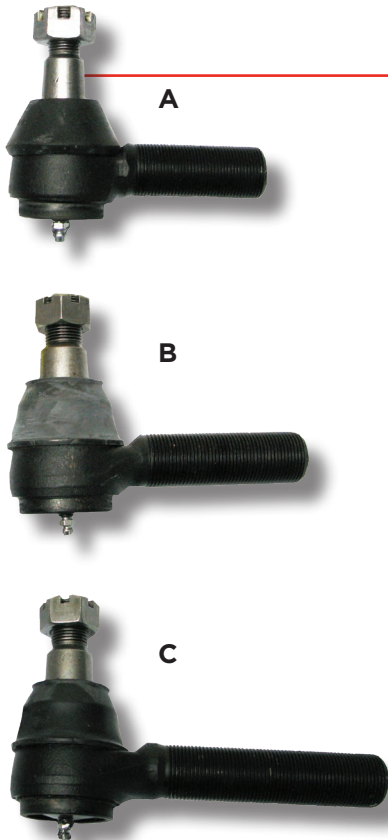

FEMALE THREAD

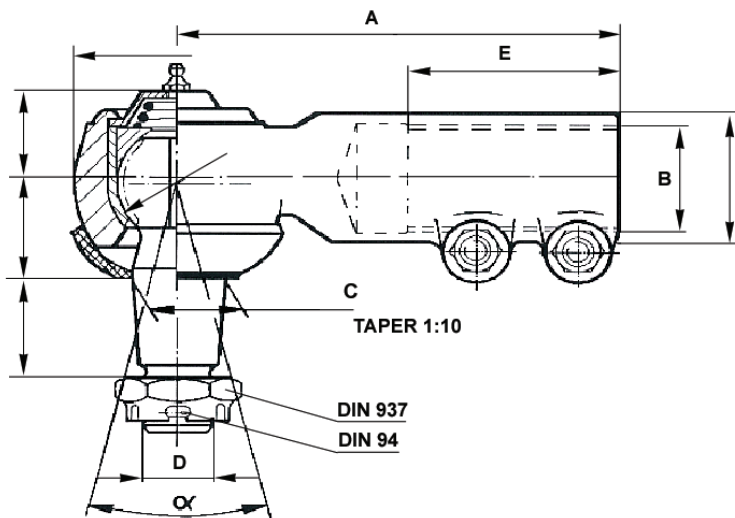
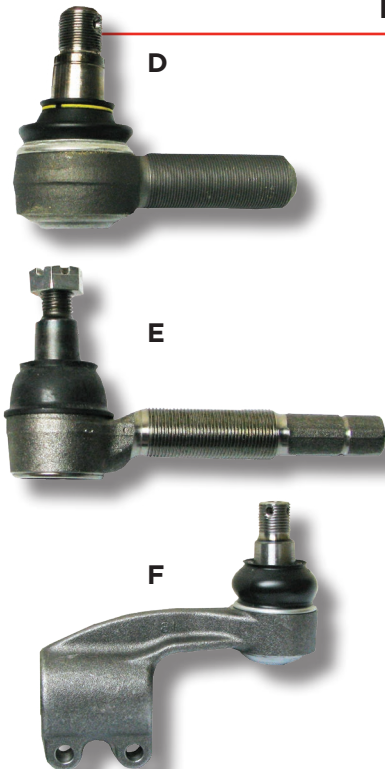

POPULAR TIE ROD ENDS

Style	Left Hand	X Ref	Application	A Length	B Thread	C Taper	Taper Minor	D Thread	Right Hand	X Ref
A	FTR-176L	R230004	International	3.88"	M 1.00"-16	.874"	.762"	5/8"-18	FTR-176R	R230005
A	FTR-187L		Ford	4.88"	M 1-1/8"-12	1.102"	.697"	7/8"-14	FTR-187L	R230061
A			International	5.5"	M 1-1/4"-12	1.102"	.967"	7/8"-14	FTR-2203R	R230051
C	FTR-2224L	R230040	Volvo	5.75"	M 1-1/4"-12	1.25"	1.117"	7/8"-14	FTR-2225R	R230056
B	FTR-411L	R230028	International	9.18"	M 1-1/8"-12	1.102"	.967"	7/8"-14	FTR-411R	R230029
C	FTR-423L	R230068	Various	5.44"	M 1-1/8"-12	1.25"	1.08"	7/8"-14	FTR-423R	R230069
C	FTR-431L	R230070	Various	5.75"	M 1-1/4"-12	1.25"	1.08"	7/8"-14	FTR-431R	R230071
D	4833829		Iveco	120mm	M 30x1.5	30mm		M 24x1.5	4833830	
E	MK997628		Mitsubishi	145mm	M 22x1.5	20mm		M 14x1.5	MK997629	
F	1431508010		Isuzu	171mm	M 56x1.5	32mm		M 22x2	1431508020	

DRAG LINK & TIE ROD ASSEMBLIES

This page can be used to help identify a Draglink where the truck chassis number is not available. Draglinks and Tie Rods have either fixed non adjustable ends as shown at top, or clamped on (adjustable and replaceable) or a combination of both. The end options include Ball joints and Bushing in a variety of styles and combinations.

FIXED NON ADJUSTABLE ASSEMBLY WITH BALL JOINT TIE ROD END

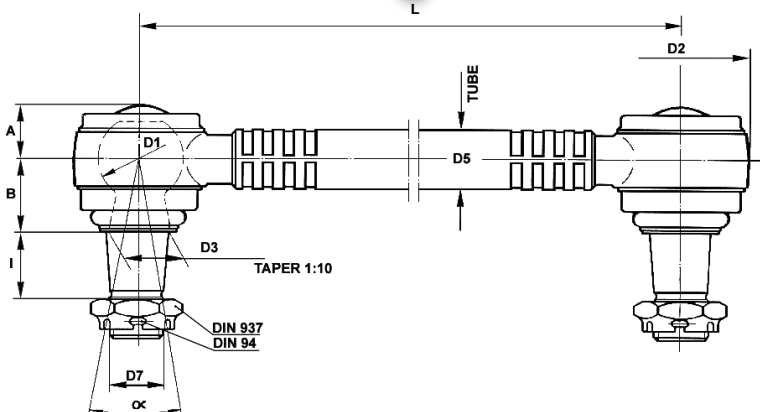

Key Measurements Taper

- A Top Centre Line
- B Bottom Centre Line
- D3 Taper Major Diam
- Taper Minor Diam
- L Length Centre to Centre
- D5 Tube Diam



NEW OR REFURBISHED TIE RODS & DRAG LINKS Talk to us today